

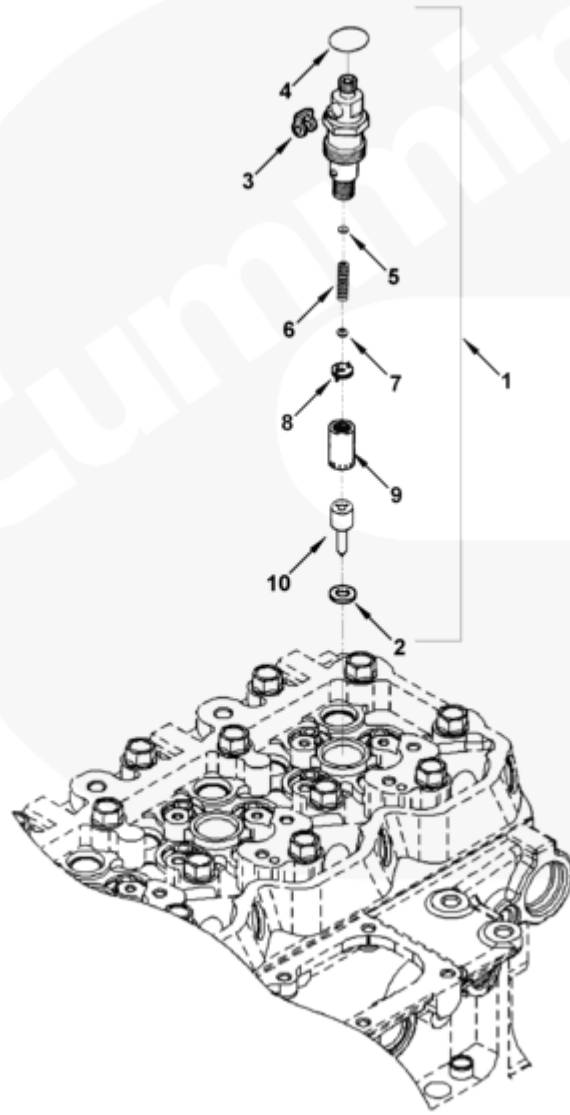

Parts Catalog - Option Detail

Electronic Parts Catalog - Option Detail				
Option	Group	Graphic	Film Card	Date
PP1523	06.01	fi900gf	T	19-SEP-97
Engines	4B3.9, 6A3.4, 6B5.9, B GAS INTERNATIONAL CM556, B4.5, B4.5 CM2350 B129B, B4.5 CM2350 B146C, B4.5 CM2350 B147B, B4.5 RGT, B4.5S, B5.9 G, B5.9 GAS PLUS CM556, B5.9 LPG, B5.9 LPG PLUS CM556, B6.7 CM2350 B121B, B6.7 CM2350 B135B, B6.7 CM2350 B136C, B6.7 CM2350 B148B, B6.7 G CMOH6.0 B125, B6.7N CM2380 B150B, B6.7S, F3.8 CM2350 F120B, F3.8 CM2350 F128C, F3.8 CM2350 F132B, F3.8 F102, G3.9, G5.9, G5.9 CM558, ISB (CHRYSLER), ISB CM2150, ISB CM2150 E, ISB CM550, ISB CM850, ISB/ISD4.5 CM2150 B119, ISB/ISD4.5 CM2150 SN, ISB/ISD6.7 CM2150 B120, ISB/ISD6.7 CM2150 SN, ISB/ISD6.7 CM2880 B126, ISB3.9 CM2220 B107, ISB4.5 CM2150, ISB5.9G CM2180, ISB6.7 2010 DCX PICKUP, ISB6.7 2013 DCX CHASSIS CAB, ISB6.7 CM2150 SQ, ISB6.7 CM2250, ISB6.7 CM2350 B101, ISB6.7 CM2350 B103, ISB6.7 CM2350 B142, ISB6.7 CM2670 B153B, ISB6.7 G CM2180 B118, ISBE CM2150, ISBE CM800, ISBE2/ISBE3 CM850, ISBE4 CM850, ISD4.5 CM2150, ISD6.7 CM2880 D101, ISF2.8 CM2220, ISF2.8 CM2220 AN, ISF2.8 CM2220 EC, ISF2.8 CM2220 ECF2, ISF2.8 CM2220 F101, ISF2.8 CM2220 F117, ISF2.8 CM2220 F122, ISF2.8 CM2220 F126, ISF2.8 CM2220 F129, ISF2.8 CM2220 IAN, ISF3.8 CM2220, ISF3.8 CM2220 AN, ISF3.8 CM2220 F103, ISF3.8 CM2220 F110, ISF3.8 CM2220 F116, ISF3.8 CM2220 F134B, ISF3.8 CM2220 IAN, ISF3.8 CM2350 F109, ISF4.5 CM2220 F123, ISG11 CM2880 G106, ISG11 CM2880 G108, ISG12 CM2880 G107, ISG12 CM2880 G109, ISG12 G CMOH6.0 G111, QSB3.9 30 CM550, QSB3.9 CM2880 B138, QSB4.5 30 CM550, QSB4.5 CM2150 B108, QSB4.5 CM2250 B131, QSB4.5 CM2250 EC, QSB4.5 CM2350 B106, QSB4.5 CM2350 B122			



f1900gf

SMALL | MEDIUM | LARGE

Cart	Ref No	Part Number	Part Description	Required	Remarks
View My Cart					
		PP1523	Fuel Injector		CPL1523
<input type="checkbox"/>	1	3802325	Injector	6	Recon Equivalent 3802325 RX
		3919298	Injector	1	
<input type="checkbox"/>	2	3906659	Injector Seal	1	For 7mm Head
	3	3903380	Banjo Connector Seal	1	Replace With 4942278
<input type="checkbox"/>	4	3909356	Rectangular Ring Seal	1	
<input type="checkbox"/>	5	3905156	Shim	A/R	1.00 mm Thick
	5	3905157	Shim	A/R	1.04 mm Thick

<input type="checkbox"/>					
<input type="checkbox"/>	5	3905158	Shim	A/R	1.08 mm Thick
<input type="checkbox"/>	5	3905159	Shim	A/R	1.10 mm Thick
<input type="checkbox"/>	5	3905160	Shim	A/R	1.14 mm Thick
<input type="checkbox"/>	5	3905161	Shim	A/R	1.18 mm Thick
<input type="checkbox"/>	5	3905162	Shim	A/R	1.20 mm Thick
<input type="checkbox"/>	5	3905163	Shim	A/R	1.24 mm Thick
<input type="checkbox"/>	5	3905164	Shim	A/R	1.28 mm Thick
<input type="checkbox"/>	5	3905165	Shim	A/R	1.30 mm Thick
<input type="checkbox"/>	5	3905166	Shim	A/R	1.34 mm Thick
<input type="checkbox"/>	5	3905167	Shim	A/R	1.38 mm Thick
<input type="checkbox"/>	5	3905168	Shim	A/R	1.40 mm Thick
<input type="checkbox"/>	5	3905169	Shim	A/R	1.44 mm Thick
<input type="checkbox"/>	5	3905170	Shim	A/R	1.48 mm Thick
<input type="checkbox"/>	5	3905171	Shim	A/R	1.50 mm Thick
<input type="checkbox"/>	5	3905172	Shim	A/R	1.54 mm Thick
<input type="checkbox"/>	5	3905173	Shim	A/R	1.58 mm Thick
<input type="checkbox"/>	5	3905174	Shim	A/R	1.60 mm thick
<input type="checkbox"/>	5	3905175	Shim	A/R	1.64 mm Thick
<input type="checkbox"/>	5	3905176	Shim	A/R	1.68 mm Thick
<input type="checkbox"/>	5	3905177	Shim	A/R	1.70 mm Thick
<input type="checkbox"/>	5	3905178	Shim	A/R	1.74 mm Thick
<input type="checkbox"/>	5	3905180	Shim	A/R	1.78 mm Thick
<input type="checkbox"/>	5	3905181	Shim	A/R	1.80 mm Thick
<input type="checkbox"/>	5	3905182	Shim	A/R	1.84 mm Thick
<input type="checkbox"/>	5	3905183	Shim	A/R	1.88 mm Thick
<input type="checkbox"/>	5	3905184	Shim	A/R	1.90 mm Thick
<input type="checkbox"/>	5	3905185	Shim	A/R	1.94 mm Thick
<input type="checkbox"/>	5	3905186	Shim	A/R	1.98 mm Thick

<input type="checkbox"/>	6	3905152	Compression Spring	6	
<input type="checkbox"/>	7	3917945	Intermediate Disc	6	
<input type="checkbox"/>	8	3917946	Pressure Spindle	6	
<input type="checkbox"/>	9	3905155	Injector Nozzle Retainer	6	
<input type="checkbox"/>	10	3919299	Nozzle	6	

© 2019 Cummins Inc., Box 3005, Columbus, IN 47202-3005 U.S.A.
Terms of Use and Disclaimers | Recommended System Requirements
Need Assistance? Please click on the Contact Us button in the top right corner of any page.